

HH CATAMARANS

PERFORMANCE | LUXURY | CARBON CONSTRUCTION



HH44

YACHTING EVOLVED

MEET THE HH44

A disruptive new market entrant designed for those seeking the perfect balance of style, performance, safety and innovation. The electrified and carbon reinforced HH44 is a game changing, eco-friendly cruising yacht, poised to win the hearts and minds of early tech adopters, world cruisers and serious sailors alike.

DECK PLAN

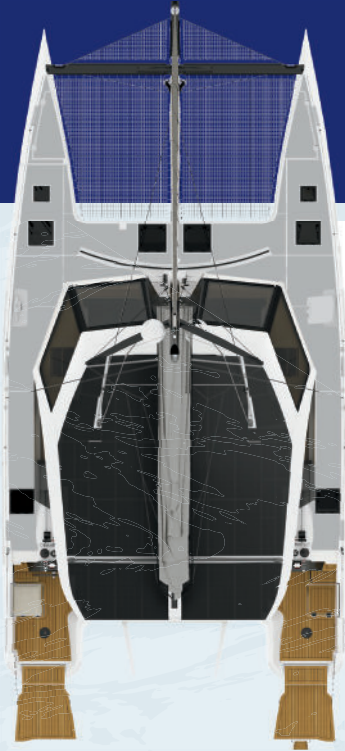

SALON

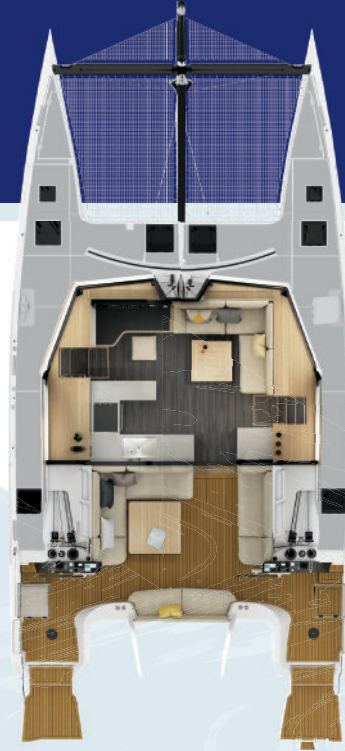

3 CABINS

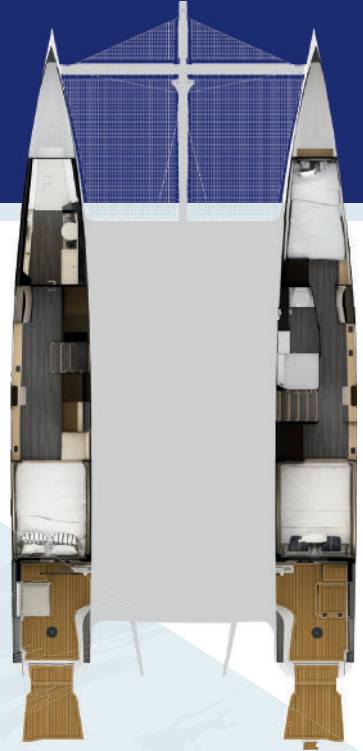

POWERED BY **EcoDrive** A PARALLEL HYBRID SYSTEM.

The HH44 was conceived from the ground up to work with a parallel diesel/electric hybrid, an industry leading 4.2kW solar array on the cabin top and hydro-regeneration while sailing.

Our EcoDrive provides all the benefits of an electric boat: silent fume free motoring, instant torque for maneuvering, and hydro-regeneration while sailing; while also providing the reliability of trusty diesel engines as a back up.

For the technology shy, traditional standalone diesel engines with shaft drives are also offered.



INNOVATIVE FEATURES

Folding transoms enhance safety at sea, and open while at anchor to increase living space and provide an easy connection with the water. Helms rotate in and out for protection, visibility, and an enhanced sailing experience. Designed with safety in mind for children and pets. Plus, carefully considered feature to provide optimal livability.



SWING HELMS & POCKET SEATS

Steer the boat from the outboard position with the wind in your hair with increased visibility of your sail plan. A fold down helm seat stows out of the way for everyday living and easily deploys when needed. Rotate the helms inboard and steer from the protection of the three-seat sofa on the aft beam.

A HOME AWAY FROM HOME

Exceptional craftsmanship and industry leading fit-and-finish is evident throughout, with foam core joinery and real wood veneers, top of the line fixtures and Bosch electric appliances standard. Cabinet locks are cleverly hidden in the modern design and a pocket TV can deploy and spin to face the viewer. Movie night has never been better.



LEARN MORE
ABOUT THE HH44 AT
HHCATAMARANS.COM/HH44



SPECIFICATIONS	OCEAN CRUISING		SPORT CRUISING	
	METRIC	IMPERIAL	METRIC	IMPERIAL
LOA	15.15 m	49.70 ft	15.15 m	49.70 ft
LWL	13.28 m	43.57 ft	13.28 m	43.57 ft
BOA	7.15 m	23.46 ft	7.15 m	23.46 ft
Air Draft	22 m	72.18 ft	22 m	72.18 ft
Draft	1.52 m	4.98 ft	1.1–3 m	3.6–9.84 ft
Bridge Deck Clearance	825 mm	2.7 ft	825 mm	2.7 ft
Displacement Light Ship	8,750 kg	19,290 lb	9,390 kg	20,701 lb
Displacement Max Load	13,500 kg	29,762 lb	13,500 kg	29,762 lb
PROPULSION	2x Beta 30hp		2x Beta 30hp + 2x 10kW parallel Hybrid Drives	
Speed Under Power	8.5 kts	8.5 kts	8.5 kts	8.5 kts
Cruising Range	628 NM	628 NM	628 NM	628 NM
SAIL AREAS				
Main Sail	74.2 m ²	799 ft ²	74.2 m ²	799 ft ²
Solent	51.1 m ²	550 ft ²	51.1 m ²	550 ft ²
Staysail	26.7 m ²	287 ft ²	26.7 m ²	287 ft ²
Fractional Reacher	109.7 m ²	1,181 ft ²	109.7 m ²	1,181 ft ²
Furling Gennaker	148.9 m ²	1,603 ft ²	148.9 m ²	1,603 ft ²
CERTIFICATION & DESIGN				
Classification	CE Category A, Module B			
Design & Structural Engineering	HH Catamarans			



HHCATAMARANS.COM